

# TECHNICAL INFORMATION

**SUBJECT:** Clutch on **ECHO CS-8002**

**Number:** Y2012-507A (1/2)  
**Issued:** May 31, 2012

<p>Changed Clutch assembly to improve clutch spring durability.</p>		
<b>CS-8002 (25)</b>	Serial Number 25001200 and before	Serial Number 25001201 and after
Clutch ASY	175000-30832	A056-000730
Clutch plate	175029-30830	Nil
Clutch plate	175019-30830	Nil
Cushion	175059-30830	Nil
Clutch hub	175016-30830	A552-000370
Clutch spring	175018-30830	A566-000210
Clutch shoe set	175002-30831	NA
Clutch shoe	NA	A555-000240
Clutch hub	Nil	A552-000360
H.S. Bolt	900105-04008	Nil
<p>Clutch ASY <u>A056-000730</u> can be used on the unit before this change.</p>		

**SERVICE HINTS:**

1. Clutch tool 897505-16133 can be used for removing and installing new clutch ASY.

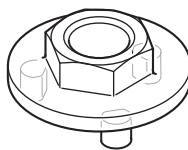

897505-16133

**TECHNICAL INFORMATION Number: Y2012-507A (2/2)**

**SERVICE HINTS: (Continued)**

**2. Disassembling and reassembling clutch parts**

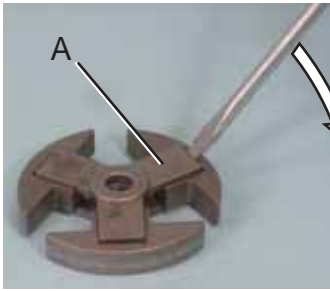

1) Pry out Clutch hub (A) using screwdriver as shown.

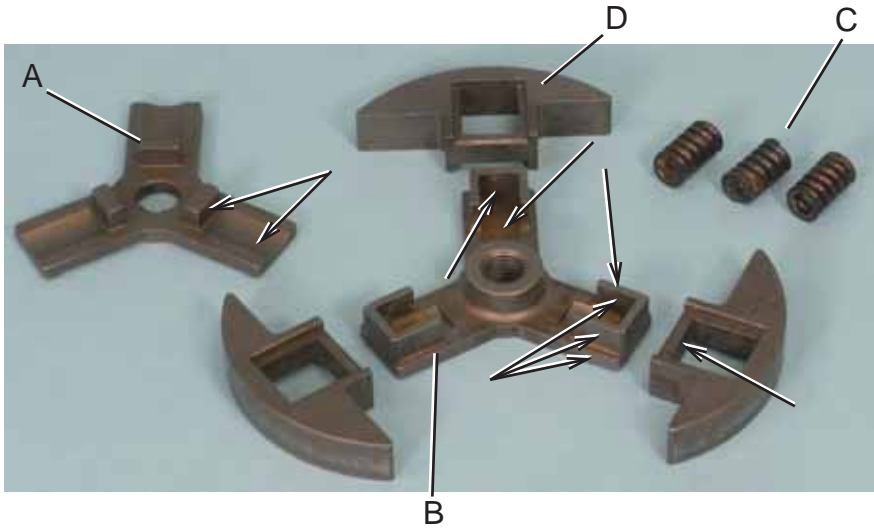

2) Before assembling clutch parts, apply thin coating of grease on sliding surfaces of clutch shoes and clutch hubs, and inside surfaces of clutch spring housing.

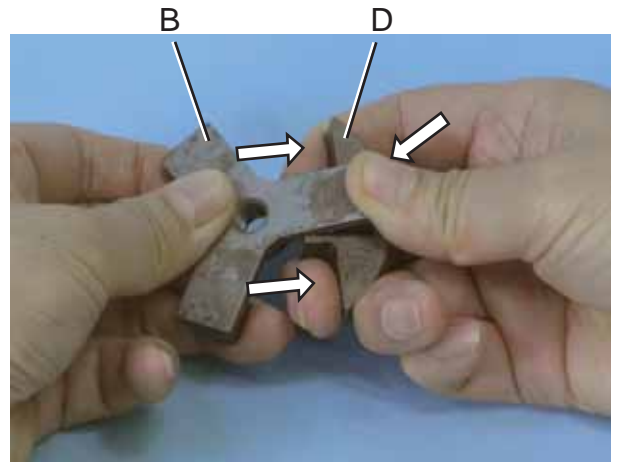
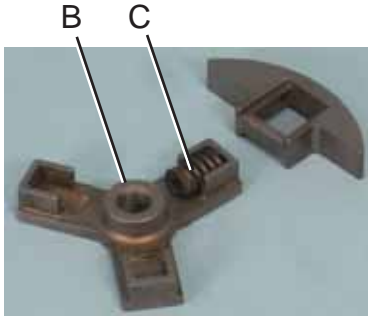

3) Set a spring (C) on clutch hub (B) as shown and assemble a clutch shoe (D) while compressing spring with it.

4) Apply the same procedure to the other two springs and shoes.

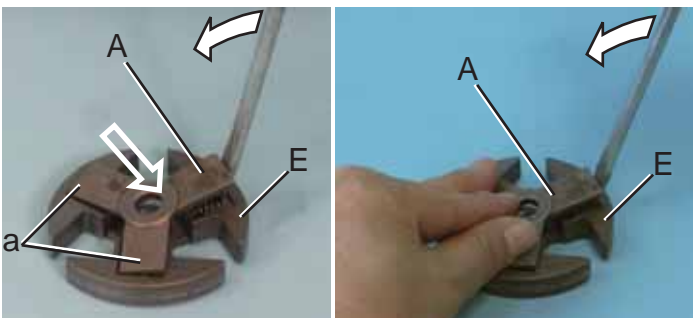

5) Set two legs (a) of clutch hub (A) as shown. Push the clutch hub (A) in while prying the shoe (E) with screw driver.